



OXFORD FAMILY ESTATES
Property Sales and Services



Warwick Road, Chapel St. Leonards, Skegness, PE24 5UL

Reduced to £230,000

🛏️ 2 🚿 1 🚗 2



Oxford Family Estates are pleased to offer for sale a very well presented inside and out Two Double Bedroom Detached Bungalow in a very sought after position and proximity to the village and beach.

The bungalow has recently had a brand new kitchen fitted and is decorated throughout to a good standard. It offers Two Double bedrooms a large lounge with a conservatory off and a bathroom with a walk in shower cubicle. It has a fully enclosed low maintenance private rear garden and ample parking. The property is a short 5 minute walk to the village centre and access points to the beach. Viewing is highly recommended.

Entrance Hallway

Kitchen 3.75max x 3.21m max (12'3"max x 10'6"max)

Lounge 5.04m x 3.88m (16'5" x 12'8")

Conservatory 3.98m x 2.70m (13'0" x 8'10")

Master Bedroom 4.27m x 3.22m (14' 0" x 10'6")

Bedroom 2 3.23m x 2.72m (10'7" x 8'11")

Bathroom 2.29m x 1.47m (7'6" x 4'9")

Garage 5.07m x 2.37m (16'7" x 7'9")

Outside Access the property via a block paved driveway leading up to the garage and to the front door providing parking for several vehicles. The rest of the frontage is laid mostly to lawn with a nice planted rockery area. There is a gate to the rear garden which has a great patio area with adjoining lawn, nice secure fencing and all very private. There is storage down the other side of the bungalow for the LPG bottles.



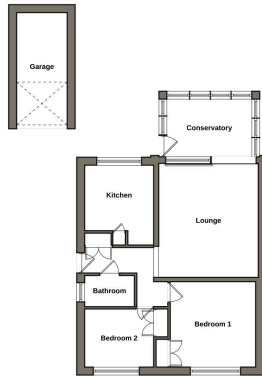

Floorplan is indicative of layout only and should not be used for accurate measurement or structural purposes.

- Detached Bungalow
- Brand New Kitchen
- Conservatory
- Very Well Presented
- Close To The Village Green
- Two Double Bedrooms
- Good Size Lounge
- Private Rear Garden
- Bathroom With Shower Cubicle
- Tax Band B Epc Rating D



Score	Energy rating	Current	Potential
92+	A		
81-91	B		
69-80	C		77 C
55-68	D	60 D	
39-54	E		
21-38	F		
1-20	G		



OXFORD FAMILY ESTATES
Property Sales and Services

